

PLAT OF SURVEY

8TH & 9TH STREET RIGHT-OF-WAY

SECTIONS 34 & 35, TOWNSHIP 2 NORTH, RANGE 7 EAST, CITY OF MONROE, GREEN COUNTY, WISCONSIN. - Part NE 1/4 & SE 1/4 Sec 34-2-7 T.H. Part SW 1/4 Sec 35-2-7 T.H.

I, Todd E. Hasse, Registered Land Surveyor, S-2228, hereby certify that I have made this Plat of Survey under the direction of Alan Gerber, Engineering Supervisor for the City of Monroe and that I have surveyed, monumented and mapped the lands described hereon and that this map is a correct representation thereof in accordance with the information provided.

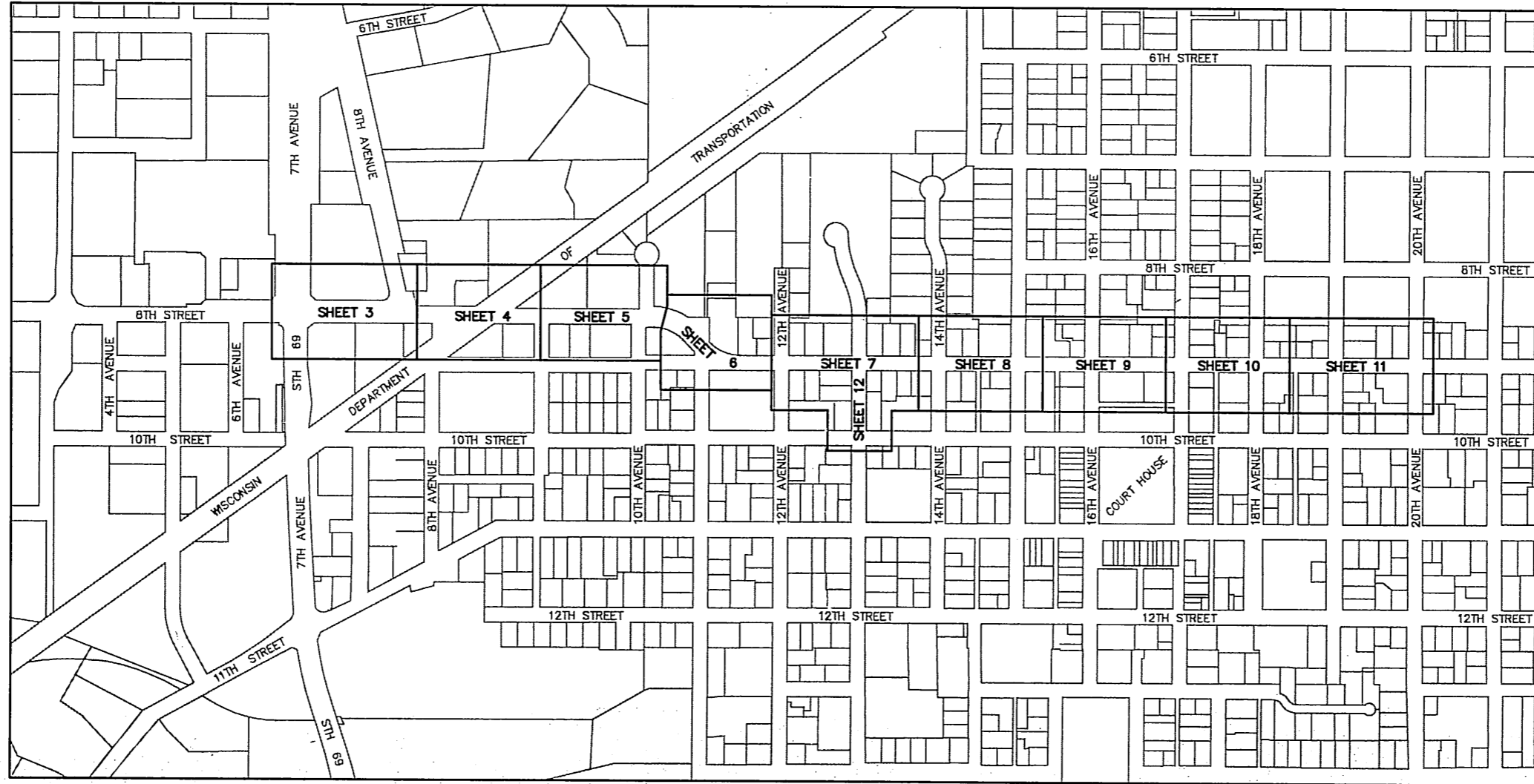

SHEET INDEX

Drawing: Not to Scale

PREPARED FOR:

City of Monroe
c/o Alan Gerber
1110 18th Avenue
Monroe, WI 53566
(608) 329-2532

JOB NO. 13108
DRAWING C:\CITYOFMONROE\8TH&9THSTREET\13108-1.DWG

SHEET 1 OF 12

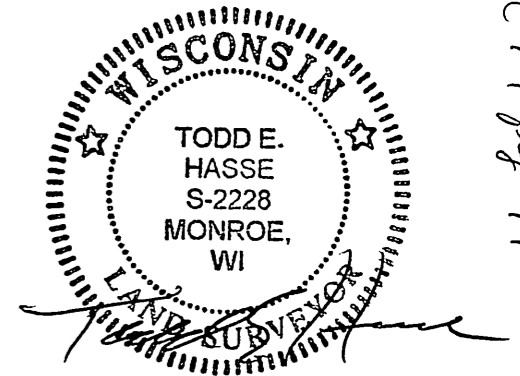

November 24th, 2013

HASSE
SURVEYING
W8820 ILIFF ROAD
MONROE, WI 53566
(608) 325-5321 PHONE
(608) 329-5321 FAX

Filed Nov. 19, 2013 Vol 14 pg 41