

# PLAT OF SURVEY

LOCATED IN THE SE 1/4-SE 1/4 AND THE SW 1/4-SE 1/4 OF SECTION 22, AND THE NE 1/4-NE 1/4, NW 1/4-NE 1/4, AND SE 1/4-NE 1/4 OF SECTION 27, ALL IN TOWN 4 NORTH, RANGE 6 EAST, TOWN OF YORK, GREEN COUNTY, WISCONSIN.

SURVEY FOR: Ronald Strommen  
N 8248 County Road A  
Blanchardville, WI 53516

SW 1/4-SE 1/4  
22

North 1/4 corner  
Section 27, T4N, R6E

Bearings are referenced to the East line of the NE 1/4 of Section 27 which bears N 00°42'09" E based on the Green County Coordinate System as defined by the Wisconsin Department of Transportation and determined by GPS Observation.

East 1/4 corner  
Section 22, T4N, R6E

SE 1/4-SE 1/4  
22

Northeast corner  
Section 27, T4N, R6E

NE 1/4-NE 1/4  
27

96.14 ACRES  
93.86± ACRES EXCL. R/W

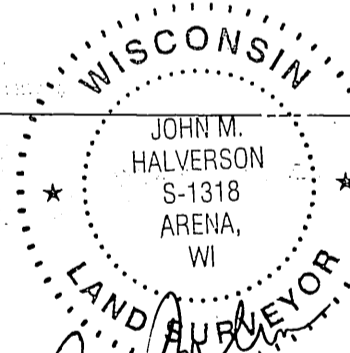

SE 1/4-NE 1/4  
27

SCALE 1"=400'

**LEGEND AND NOTES**

- Found 3/4" rebar
- ⊕ Found cast aluminum monument
- △ Set railroad spike in pavement
- Set 3/4"x24" rebar
- ( ) Recorded as

East 1/4 corner  
Section 27, T4N, R6E

South 1/4 corner  
Section 27, T4N, R6E

Filed Feb 28, 2013 UBF 13 pg 120