

- LEGEND**
- GOVERNMENT CORNER
 - 3/4" REBAR FOUND
 - SEPTIC TANK
 - PARCEL BOUNDARY
 - SECTION LINE
 - EASEMENT LINE
 - PLATTED LOT LINE
 - FENCE LINE
 - EDGE OF PAVEMENT
 - BUILDING
 - BITUMINOUS PAVEMENT
 - CONCRETE PAVEMENT
 - RECORDED INFORMATION

- NOTES**
1. FIELD WORK PERFORMED BY JSD PROFESSIONAL SERVICES, INC. ON AUGUST 4, 2011.
 2. BEARINGS FOR THIS SURVEY AND MAP ARE REFERENCED TO THE SOUTH LINE OF THE SOUTHWEST QUARTER, RECORDED AS N 88°09'22" W.
 3. THIS PARCEL IS SUBJECT TO ALL EASEMENTS AND AGREEMENTS, BOTH RECORDED AND UNRECORDED.

LEGAL DESCRIPTION

LOT 1 OF CERTIFIED SURVEY MAP NO. 268 IN VOLUME 1 OF CERTIFIED SURVEY MAPS DANE COUNTY CERTIFIED SURVEYS PAGE 275 BEING A PART OF THE SOUTHWEST 1/4 OF THE SOUTHWEST 1/4 OF SECTION 2, TOWN 4 NORTH, RANGE 8 EAST, GREEN COUNTY, WISCONSIN.

ALSO AN EASEMENT 2 RODS WIDE FOR INGRESS AND EGRESS WITHIN AN AREA BEING THE SOUTH 200 FEET OF THE WEST 804.71 FEET OF THE SOUTHWEST 1/4 OF THE SOUTHWEST 1/4 IN SECTION 2, TOWN 4 NORTH, RANGE 8 EAST.

SURVEYOR'S CERTIFICATE

I, JOHN KREBS, WISCONSIN REGISTERED LAND SURVEYOR NO. S-1878, HEREBY CERTIFY THAT THIS BOUNDARY SURVEY AND MAP IS CORRECT TO THE BEST OF MY KNOWLEDGE AND BELIEF IN ACCORDANCE WITH THE INFORMATION PROVIDED.

John Krebs
 JOHN KREBS, S-1878
 WISCONSIN REGISTERED LAND SURVEYOR

8/8/11
 DATE

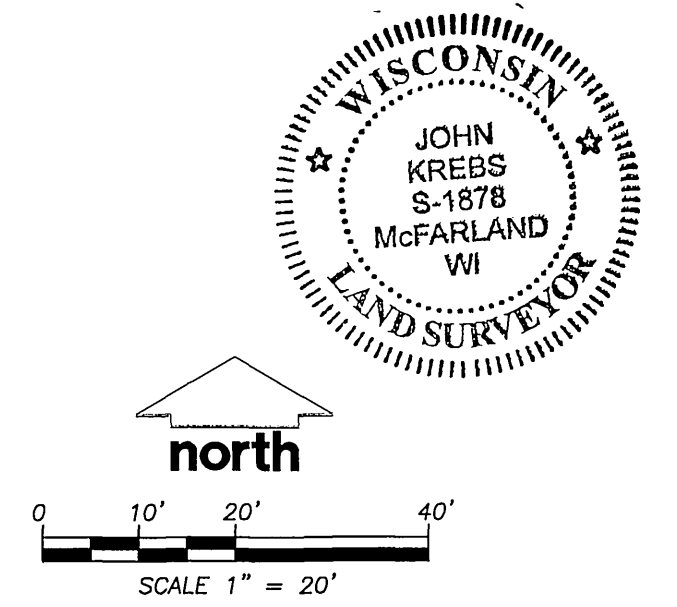

DATE	DESCRIPTION	REVISION	BY
08-03-2011			
08-05-2011			
08-08-2011			

DATE	DESCRIPTION
08-03-2011	JK
08-05-2011	DRS
08-08-2011	HPJ

PROJECT NO.: 11-4806
 FILE NO.: C-288
 SURVEYED: JK
 F.B. NO./PG.: 248/52
 SHEET NO.: 1 OF 1

PREPARED FOR
 LUIN HATLEBERG
 N9302 HWY 92
 BELLEVILLE, WI 53508

PLAT OF SURVEY

LOT 1 OF CERTIFIED SURVEY MAPS NO. 268, RECORDED IN VOLUME 1 OF CERTIFIED SURVEY MAPS OF GREEN COUNTY, ON PAGE 275, BEING A PART OF THE SOUTHWEST QUARTER OF THE SOUTHWEST QUARTER OF SECTION 2, TOWNSHIP 4 NORTH, RANGE 8 EAST, GREEN COUNTY, WISCONSIN.

Professional Services, Inc.
 Engineers • Surveyors • Planners
 161 HORIZON DRIVE, SUITE 101
 VERONA, WISCONSIN 53593
 PHONE: (608)848-5060

Filed Aug 15, 2011 Vol 13 Pg 25