

PLAT OF SURVEY

That part of the NW 1/4 of the SE 1/4 of Section 13, Town 2 North, Range 7 East, Township of Monroe, Green County, Wisconsin, bounded and described as follows:

Commencing at the S 1/4 corner of Section 13; thence N0°15'47"W along the W. line of the SE 1/4 of Section 13, 1321.18' to the point of beginning; thence N0°15'47"W along said W. line, 1321.18' to the center of Section 13; thence N89°55'13"E along the N. line of the SE 1/4 of Section 13, 25.30'; thence S0°48'03"E, 1321.31' to the S. line of the NW 1/4 of the SE 1/4 of Section 13; thence S89°58'03"W along said S. line, 37.70' to the point of beginning; subject to any and all easements of record.

I, Todd E. Hasse, Registered Land Surveyor, S-2228, hereby certify that I have made this Plat of Survey under the direction of Attorney Peter B. Kelly and that I have surveyed, monumented and mapped the lands described hereon and that this map is a correct representation thereof in accordance with the information provided.

May 7th, 2010

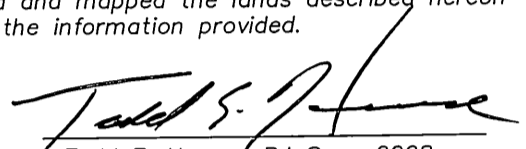
Todd E. Hasse R.L.S. - 2228

NOTES:

1. Bearings and distances shown in parenthesis, indicates recorded as data.
2. Bearings are referenced to the W. line of the SE 1/4 of Section 13, which bears N0°15'47"W, according to the Green County Coordinate System, as defined by the Wisconsin Department of Transportation and determined by GPS observation.
3. This survey was prepared to monument the easterly property corners of a Parcel that was sold to Daniel E. Roeschli on November 15th, 2001 (Warranty Deed Recorded in Volume 698, Page 638, as Document No. 421937, Parcel No. 23-20-209.100).

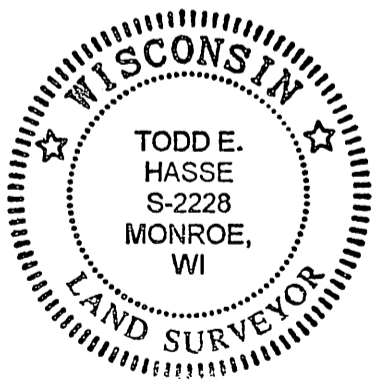

Filed June 15, 2010 Vol 12 pg 116