

LEGAL DESCRIPTION PER Q.C.D. 508538

- A** The West 37 rods off of the South One-Fourth of the Southwest Quarter of the Northwest Quarter of Section 29, Town 4 North, Range 7 East, Town of New Glarus, Green County, Wisconsin.
- B** The West Half of the Southwest Quarter lying North of the highway of Section 29, Town 4 North, Range 7 East, Town of New Glarus, Green County, Wisconsin. 23-24-226.0 and 23-24-232.0
Parcel Identification Number (PIN)
- C** The South 1/4 of the Southeast Quarter of the Northeast Quarter of Section 30, Town 4 North, Range 7 East, Town of New Glarus, Green County, Wisconsin.
- D** The East Half of the East Half of the Southeast Quarter lying North of the highway and the Northwest Quarter of the Northeast Quarter of the Southeast Quarter lying North of the highway of Section 30, Town 4 North, Range 7 East, Town of New Glarus, Green County, Wisconsin.

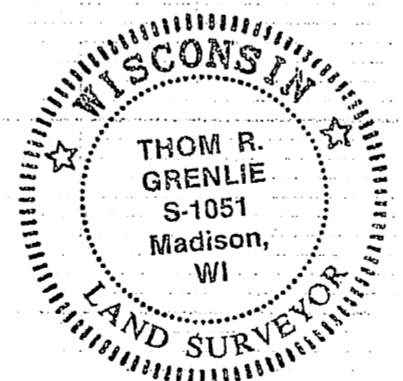

THOM R. GRENLIE

REGISTERED LAND SURVEYOR

400 S. NINE MOUND ROAD, VERONA, WIS. 53593 (608) 845-6882

SURVEY PLAT MAP

LEGEND

Scale: 1 inch = 200 ft.

- iron stake set
- iron stake found Tape/File
- ▽ P.K. Nail in E

Surveyed By TG HC

Drawn By HC

Approved By _____

Field Book 150-6

Survey Date 5-4-09

Map No. 3666-L

Revised: FINAL: 9-22-09

848-6239

SURVEYED FOR: PEG SCHMIDT & ROBERTA KURTZ
321 THOMPSON ST. VERONA, WI 53593

DESCRIPTION-LOCATION: PRT SEC. 29 & 30,
T4N, R7E, TOWN OF NEW GLARUS, GREEN CO, WI

SEE DESCRIPTION ON DEED

SURVEYOR'S CERTIFICATE

I hereby certify that I have surveyed and mapped the lands described hereon and that the map is a correct representation in accordance with the information provided.

Thom R. Grenlie

Thom R. Grenlie S-1051

Filed Oct 27, 2009 Vol 12 pg 92