

LEGEND

⊕	GOVERNMENT CORNER	⊕	TV ANTENNA TOWER
○	1/4" REBAR SET (1.50 LBS/LF)	---	PARCEL BOUNDARY
⊗	UNMONUMENTED CORNER	---	SECTION LINE
●	1 1/4" REBAR FOUND	---	PROPERTY LINE
●	3/4" REBAR FOUND	---	EASEMENT LINE
⊕	BENCHMARK	---	RIGHT-OF-WAY LINE
⊕	FINISHED FLOOR SHOT LOCATION	---	CENTERLINE
⊕	SOIL BORING	---	LANDSCAPE LIMITS
⊕	BOLLARD	-X-X-	FENCE LINE
⊕	MAIL BOX	---	EDGE OF PAVEMENT
⊕	POST	---	CONCRETE CURB & GUTTER
⊕	SIGN	G	NATURAL GAS
⊕	MANHOLE	Pe	OVERHEAD ELECTRIC
⊕	CABLE PEDESTAL	Pu	UNDERGROUND ELECTRIC
⊕	ELECTRIC TRANSFORMER	Ssn	SANITARY SEWER
⊕	AIR CONDITION UNIT	Ssm	STORM SEWER
⊕	POWER POLE W/GUY	Tu	UNDERGROUND TELEPHONE
⊕	LIGHT POLE	Tu	OVERHEAD TELEPHONE
⊕	GAS REGULATOR/METER	W	WATER LINE
⊕	TELEPHONE PEDESTAL	---	DITCH LINE
⊕	SANITARY MANHOLE	---	EDGE OF WOODS OR BRUSH
⊕	STORM MANHOLE	---	FOUNDATION LINE
⊕	ROUND CASTED INLET	---	SPOT ELEVATION
⊕	CURB INLET	---	BITUMINOUS PAVEMENT
⊕	WATER MANHOLE	---	CONCRETE PAVEMENT
⊕	HYDRANT	---	GRAVEL OR ROCK
⊕	CLEAN OUT	---	INDEX CONTOUR
⊕	WATER OR GAS VALVE	---	INTERMEDIATE CONTOUR
>	ENDWALL/END OF PIPE	()	RECORDED INFORMATION

NOTES

- BEARINGS FOR THIS SURVEY AND MAP ARE REFERENCED TO THE WESTERLY LINE OF LOT 1, CSM NO. 4143, RECORDED AS N 02°50'50" E.
- ELEVATIONS FOR THIS SURVEY AND MAP ARE BASED ON AN ASSUMED VERTICAL DATUM. BENCHMARK IS THE RIM OF SANITARY SEWER MANHOLE NO. 22, ASSUMED ELEVATION OF 143.76.
- CONTOUR INTERVAL IS ONE FOOT.
- SPOT ELEVATIONS SHOWN ALONG CURB AND GUTTER ARE REFERENCED TO THE TOP BACK OF CURB.
- FIELD WORK PERFORMED BY JSD PROFESSIONAL SERVICES, INC. THE WEEKS OF FEBRUARY 4, MAY 5, MAY 19, AND JUNE 9, 2008.
- SUBSURFACE UTILITIES AND FEATURES SHOWN ON THIS MAP HAVE BEEN APPROXIMATED BY LOCATING SURFICIAL FEATURES AND APPURTENANCES, LOCATING DIGGERS HOTLINE FIELD MARKINGS AND BY REFERENCE TO UTILITY RECORDS AND MAPS. DIGGER'S HOTLINE TICKET NO.'S: 20081201942, 20081202009 AND 20081202015.
- BEFORE EXCAVATION, APPROPRIATE UTILITY COMPANIES SHOULD BE CONTACTED, FOR EXACT LOCATION OF UNDERGROUND UTILITIES, CONTACT DIGGERS HOTLINE, AT 1.800.242.8511.
- THE ACCURACY OF THE BENCHMARKS SHOWN ON THIS MAP SHALL BE VERIFIED BEFORE BEING UTILIZED. JSD PROFESSIONAL SERVICES, INC. DOES NOT WARRANT THE ACCURACY OF THESE CONTROL POINTS AND BENCHMARKS.
- THIS PARCEL IS SUBJECT TO ALL EASEMENTS AND AGREEMENTS, BOTH RECORDED AND UNRECORDED.
- HASLEN DRIVE FROM SIXTH STREET WEST TO EIGHTH STREET, AND THAT PORTION OF EIGHTH STREET LYING NORTH OF THIRD AVENUE WERE PLATTED VIA THE 1962 REVISION OF PART OF NEW GLARUS ASSESSOR'S PLAT. THE VILLAGE OF NEW GLARUS COULD FIND NO RECORDED DOCUMENTATION TO INDICATE THESE PLATTED RIGHTS OF WAY HAVE BEEN VACATED. THAT PORTION OF SEVENTH STREET LYING NORTH OF THIRD AVENUE WAS VACATED BY VILLAGE OF NEW GLARUS RESOLUTION NO. R99-4.

LEGAL DESCRIPTION (AS SURVEYED)

PARCEL A
 LOT 1, CERTIFIED SURVEY MAP (CSM) NO. 670 AS RECORDED IN VOLUME 2 OF GREEN COUNTY CERTIFIED SURVEY MAPS ON PAGE 223 AS DOCUMENT NUMBER 388351, PART OF OUTLOT 7, NEW GLARUS ASSESSOR'S PLAT, LOCATED IN THE WEST HALF OF THE SOUTHWEST 1/4 OF SECTION 14, AND LOT 1, CSM NO. 4143 AS RECORDED IN VOLUME 16 OF GREEN COUNTY CERTIFIED SURVEY MAPS ON PAGE 203 AS DOCUMENT NUMBER 483624, PART OF OUTLOT 1, NEW GLARUS ASSESSOR'S PLAT AND PART OF OUTLOT 2B, 1962 REVISION OF PART OF NEW GLARUS ASSESSOR'S PLAT LOCATED IN THE EAST HALF OF THE SOUTHWEST 1/4 OF SECTION 15, AND PART OF THE SOUTHWEST 1/4 OF THE NORTHEAST 1/4 OF SECTION 15, ALL IN T4N, R7E, VILLAGE OF NEW GLARUS, GREEN COUNTY, WISCONSIN, DESCRIBED AS FOLLOWS:

BEGINNING AT THE WEST 1/4 CORNER OF SAID SECTION 14; THENCE SOUTH 00°00'53" WEST ALONG THE WEST LINE OF THE SOUTHWEST 1/4 OF SAID SECTION 14, 186.65 FEET TO THE NORTHWEST CORNER OF LOT 1 OF SAID CSM 670; THENCE SOUTH 72°31'31" EAST ALONG THE NORTH LINE OF SAID LOT 1, 686.56 FEET TO THE NORTHEAST CORNER THEREOF; THENCE SOUTH 00°10'06" WEST ALONG THE EAST LINE OF SAID LOT 1, 883.83 FEET TO THE NORTH RIGHT-OF-WAY LINE OF SAID SECOND AVENUE; THENCE ALONG SAID NORTH RIGHT-OF-WAY LINE, NORTH 80°00'00" WEST, 687.87 FEET TO THE WEST RIGHT-OF-WAY LINE OF EIGHTH STREET; THENCE SOUTH 00°00'53" WEST ALONG SAID WEST RIGHT-WAY LINE, 352.81 FEET TO THE NORTHERLY RIGHT-OF-WAY LINE OF THIRD AVENUE; THENCE ALONG SAID NORTHERLY RIGHT-OF-WAY LINE SOUTH 88°54'30" WEST, 1.25 FEET TO A CURVE; THENCE ALONG SAID NORTHERLY RIGHT-OF-WAY LINE 184.81 FEET ALONG THE ARC OF A 258.73 FOOT RADIUS CURVE TO THE RIGHT SUBTENDED BY A LONG CHORD BEARING NORTH 72°47'51" WEST, 161.84 FEET; THENCE NORTH 54°37'00" WEST ALONG SAID NORTHERLY RIGHT-OF-WAY LINE, 334.47 FEET TO A POINT OF CURVATURE; THENCE ALONG SAID NORTHERLY RIGHT-OF-WAY LINE 445.69 FEET ALONG THE ARC OF A 325.00 FOOT RADIUS CURVE TO THE LEFT SUBTENDED BY A LONG CHORD BEARING SOUTH 86°01'05" WEST, 412.27 FEET; THENCE SOUTH 39°14'02" WEST, 33.00 FEET TO A POINT ON THE CURVED CENTERLINE OF BURST ROAD; THENCE ALONG SAID CENTERLINE 242.81 FEET ALONG THE ARC OF 340.00 FOOT RADIUS CURVE TO THE LEFT SUBTENDED BY A LONG CHORD BEARING NORTH 71°13'28" WEST, 237.68 FEET TO THE WEST LINE OF SAID CSM NO. 4143; THENCE ALONG SAID WEST LINE NORTH 02°50'50" EAST, 1332.09 FEET TO THE NORTHWEST CORNER THEREOF; THENCE NORTH 88°05'09" EAST ALONG THE NORTH LINE OF SAID LOT 1, 687.33 FEET; THENCE NORTH 00°00'35" EAST, 62.21 FEET; THENCE NORTH 86°33'02" EAST, 41.01 FEET; THENCE SOUTH 80°50'07" EAST, 329.29 FEET TO THE POINT OF BEGINNING.

SAID PARCEL CONTAINS 2,191,649 SQUARE FEET OR 50.313 ACRES, INCLUDING RIGHT-OF-WAY.

PARCEL B
 ALL OF OUTLOTS 23A & 23B, 1962 REVISION OF PART OF NEW GLARUS ASSESSOR'S PLAT, AND THAT PART OF SEVENTH STREET VACATED PER VILLAGE OF NEW GLARUS RESOLUTION R99-4.

SAID PARCEL CONTAINS 69,340 SQUARE FEET OR 1.591 ACRES.

SURVEYOR'S CERTIFICATE

I, DAVE M. JENKINS, WISCONSIN LAND SURVEYOR S-2255, HEREBY CERTIFY THAT THIS EXISTING CONDITIONS SURVEY AND MAP IS CORRECT TO THE BEST OF MY KNOWLEDGE AND BELIEF IN ACCORDANCE WITH THE INFORMATION PROVIDED.

DAVE M. JENKINS, S-2255
 WISCONSIN LAND SURVEYOR

DATE 06/16/09 PREPARED FOR
 NEW GLARUS HOME, INC.
 600 2ND AVENUE
 NEW GLARUS, WI 53574

EXISTING CONDITIONS SURVEY

LOT 1, CSM 670, LOT 1, CSM 4143, PART OF OUTLOTS 1, 2, 7, AND LOTS 23A & 23B, ASSESSOR'S PLAT OF NEW GLARUS, AND PART OF THE SE 1/4 OF THE NE 1/4 OF SECTION 15, T4N, R7E, VILLAGE OF NEW GLARUS, GREEN COUNTY, WISCONSIN

DATE: 6-13-2008
 DRAWN BY: SO
 CHECKED BY: JK
 APPROVED BY: DMJ
 DATE: 6-16-2008
 DATE: 6-16-2008

DESCRIPTION: U:\2007\072790.dwg 07-2790 Ex-Con.dwg

PROJECT NO.: 07-2780
 FILE NO.: D-114
 SURVEYED: MAD/MSO
 F.B. NO./PG.: 219/59
 SHEET NO.: 4 OF 5

To obtain locations of participant underground facilities before you dig in Wisconsin

CALL DIGGERS HOTLINE
 1-800-242-8511 TOLL FREE

WISCONSIN DIGGERS HOTLINE (800) 242-8511
 WISCONSIN DIGGERS HOTLINE (800) 242-8511
 WISCONSIN DIGGERS HOTLINE (800) 242-8511

THE INFORMATION SHOWN ON THIS DRAWING CONCERNING THE TYPE AND LOCATION OF UNDERGROUND UTILITIES IS NOT GUARANTEED TO BE ACCURATE OR ALL INCLUSIVE. THE CONTRACTOR IS RESPONSIBLE FOR MAKING THE CONTRACTOR'S OWN DETERMINATIONS AS TO THE TYPE AND LOCATION OF UNDERGROUND UTILITIES AS MAY BE NECESSARY TO AVOID DAMAGE.

CURVE TABLE

CURVE	LENGTH	RADIUS	DELTA	CHORD	CHORD BEARING
C-1	164.61'	258.73'	36°27'07"	161.84'	N 72°47'51" W
	(164.59')		(38°28'30")	(161.94')	(N 72°51'15" W)
C-2	446.58'	325.00'	78°43'50"	412.27'	S 86°01'05" W
C-3	242.81'	340.00'	40°56'01"	237.68'	N 71°13'28" W
	(242.95')		(40°56'26")	(237.81')	(N 71°12'06" W)
C-4	263.76'	373.00'	40°30'55"	258.30'	N 71°01'26" W
	(263.92')		(40°32'24")	(258.45')	(N 71°00'04" W)

EASEMENT CURVE TABLE

CURVE	LENGTH	RADIUS	DELTA	CHORD	CHORD BEARING
EC-1	84.80'	155.00'	31°20'42"	83.74'	S 14°59'26" E
EC-2	267.45'	248.00'	61°47'18"	254.67'	S 30°12'44" E
EC-3	40.00'	373.00'	06°08'39"	39.98'	N 53°50'17" W
					(N 53°48'12" W)
EC-4	24.98'	325.00'	14°24'11"	24.99'	S 48°51'23" W

LINE TABLE

LINE	LENGTH	CHORD BEARING
L-1	1.25'	S 88°54'30" W
L-2	33.00'	S 39°14'02" W
		(S 39°16'08" W)
L-3	13.44'	S 39°14'02" W
		(S 39°16'08" W)

EASEMENT LINE TABLE

LINE	LENGTH	CHORD BEARING
E-1	25.00'	N 45°00'14" E
		(N 45°00'00" E)
E-2	41.63'	S 53°23'33" E
		(S 53°21'50" E)

BENCHMARKS

BENCH MARK	ELEVATION	DESCRIPTION
BM-1	143.86	RIM OF SANITARY SEWER MANHOLE NO. 22
BM-2	207.69	BRASS CAP MONUMENT MARKING THE W 1/4 COR. OF SECTION 14-4-7
BM-3	116.54	RIM OF SANITARY SEWER MANHOLE NO. 11
BM-4	128.30	RIM OF SANITARY SEWER MANHOLE NO. 12
BM-5	193.69	3/4" REBAR MARKING THE NW CORNER OF LOT 1, CSM 4143
BM-6	104.30	3/4" REBAR 4.0' NORTH OF THE SW CORNER OF LOT 1, CSM 4143

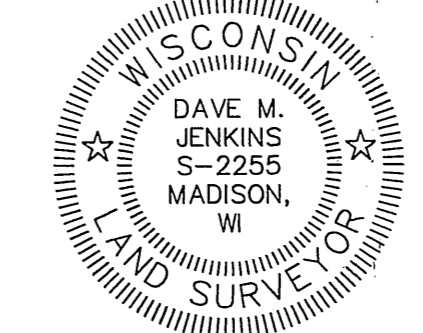
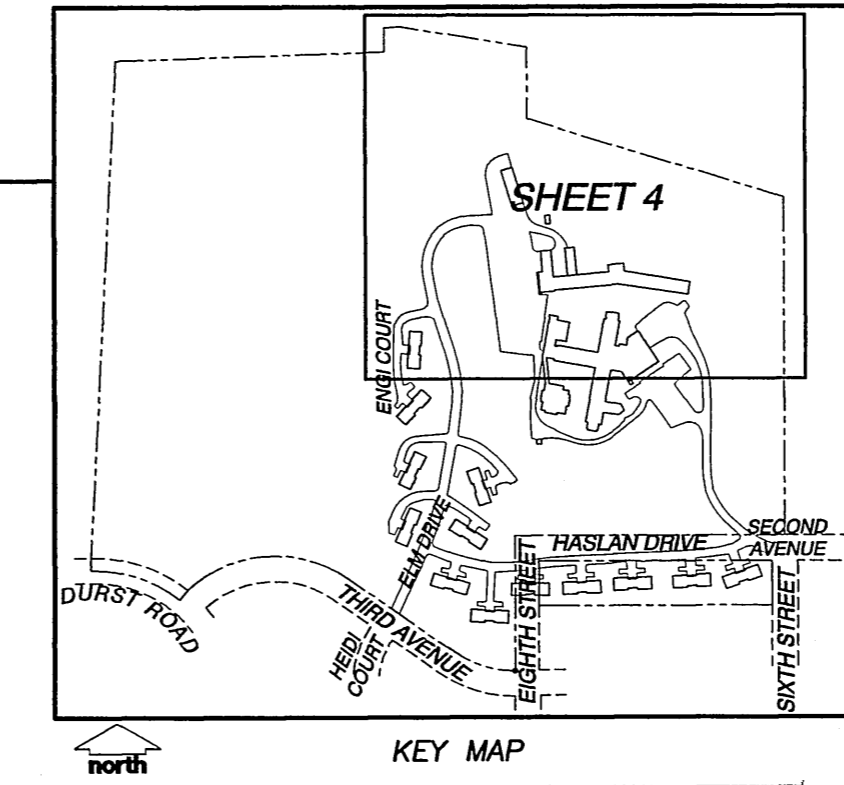
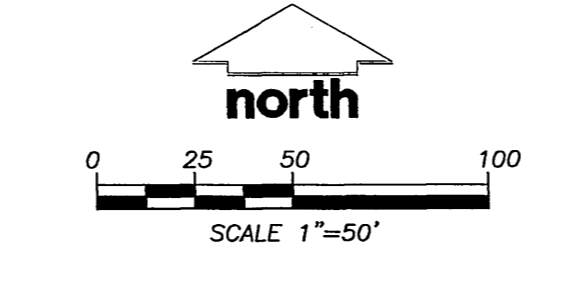

Jul 9, 2009 10:12:13 AM