

LEGEND

- 3/4" REBAR FOUND
- 3/4" REBAR SET
- ⊕ BM-1 BENCHMARK
- BOLLARD
- STREET SIGN
- ⊕ WATER OR GAS VALVE
- ⊕ FIRE HYDRANT
- ⊕ SANITARY SEWER MANHOLE
- ⊕ UTILITY POLE WITH GUY WIRE
- ⊕ GUY ANCHOR
- ⊕ UTILITY PEDESTAL
- ⊕ SPOT ELEVATION
- ▭ BUILDINGS
- ▭ PROPERTY LINE
- ▭ EDGE OF GRAVEL
- ▭ RIGHT OF WAY LINE
- ▭ CENTER LINE
- ▭ EASEMENT LINE
- ▭ WATER LINE
- ▭ SANITARY SEWER
- ▭ STORM SEWER
- ▭ OVERHEAD CABLE
- ▭ OVERHEAD ELECTRICAL POWER
- ▭ OVERHEAD TELEPHONE
- ▭ PAVEMENT EDGE
- ▭ BITUMINOUS PAVEMENT
- ▭ INDEX CONTOUR
- ▭ INTERMEDIATE CONTOUR
- () RECORDED INFORMATION

- NOTES**
- FIELD WORK PERFORMED BY JENKINS SURVEY & DESIGN, INC. THE WEEK OF JUNE 18, 2007.
 - BEARINGS ARE REFERENCED TO THE NORTHWESTERLY LINE OF C.S.M. NO. 4043, RECORDED AS N 31°17'00" E.
 - ELEVATIONS ARE BASED ON VILLAGE OF ALBANY VERTICAL DATUM. BENCHMARK IS A CHIEF SQUARE ON A LIFT STATION 200 FEET EAST OF DIXON DRIVE. ELEVATION = 817.13' AS PROVIDED BY MEAD & HUNT.
 - CONTOUR INTERVAL IS 1 FOOT.
 - SUBSURFACE UTILITIES AND FEATURES SHOWN ON THIS MAP HAVE BEEN APPROXIMATED BY LOCATING SURFICIAL FEATURES AND APPURTENANCES, LOCATING DIGGERS HOTLINE FIELD MARKINGS AND BY REFERENCE TO UTILITY RECORDS AND MAPS. DIGGER'S HOTLINE TICKET NUMBER 20072417188.
 - BEFORE EXCAVATION, APPROPRIATE UTILITY COMPANIES SHOULD BE CONTACTED FOR EXACT LOCATION OF UNDERGROUND UTILITIES. CONTACT DIGGERS HOTLINE AT 1.800.242.8511.
 - THE ACCURACY OF THE BENCHMARKS SHOWN ON THIS MAP SHALL BE VERIFIED BEFORE BEING UTILIZED. JENKINS SURVEY AND DESIGN DOES NOT WARRANT THE ACCURACY OF THESE BENCHMARKS.

LEGAL DESCRIPTION (FURNISHED)

LOT ONE (1) CERTIFIED SURVEY MAP NO. 4043, IN THE VILLAGE OF ALBANY, GREEN COUNTY, WISCONSIN.

SAID PARCEL CONTAINS 168,280 SQUARE FEET OR 3.863 ACRES.

SAID PARCEL IS SUBJECT TO ALL EASEMENTS AND AGREEMENTS, RECORDED AND UNRECORDED.

SURVEYOR'S CERTIFICATE:

I, JOHN KREBS, S-1878, HEREBY CERTIFY THAT THIS EXISTING CONDITIONS SURVEY AND MAP IS CORRECT TO THE BEST OF MY KNOWLEDGE AND BELIEF IN ACCORDANCE WITH THE INFORMATION PROVIDED.

John Krebs 7-3-07
 JOHN KREBS, S-1878 DATE
 PROFESSIONAL LAND SURVEYOR

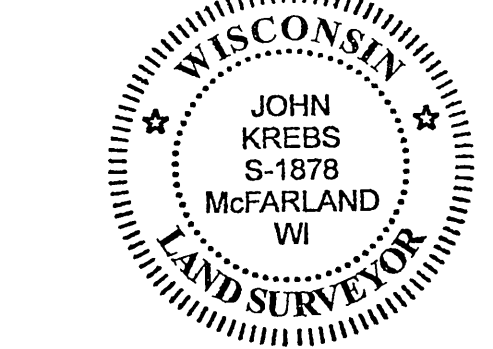

CURVE TABLE

CURVE	LENGTH	RADIUS	DELTA	TANGENT	CHORD	CHORD BEARING
1-2	113.14"	206.00'	31°28'02"	58.03'	111.72'	S 78°50'45" E
3-4	503.55'	475.00'	60°44'23"	278.34'	480.30'	S 25°47'25" W

SANITARY SEWER MANHOLES

STRUCT. ID	RIM ELEVATION	INVERT ELEVATION	PIPE SIZE	PIPE TYPE
SAN-1	818.27	NE 809.04	8"	PVC
		SW 809.55	8"	PVC
SAN-2	816.45	NE 807.90	8"	PVC
		SW 807.76	8"	PVC
SAN-3	814.61	NE 806.75	8"	PVC
		SW 806.76	8"	PVC
SAN-4	815.64	NE 805.67	8"	PVC
		NW 805.45	8"	PVC
SAN-5	815.61	SE 805.65	8"	PVC
		N 805.86	8"	PVC
		SE 805.82	8"	PVC

BENCHMARKS

BENCH MARK	ELEVATION	DESCRIPTION
BM-1	818.91'	TOP NUT OF HYDRANT AT S.T.H. 59 & ODGEN AVENUE
BM-2	817.60'	TOP NUT OF HYDRANT 446' NE OF VALVE AT ODGEN AVENUE

TO OBTAIN LOCATIONS OF PARTICIPANT UNDERGROUND UTILITIES BEFORE YOU DIG OR EXCAVATE

CALL DIGGERS HOTLINE
 1-800-242-8511 TOLL FREE

WISCONSIN TOWN DANCE AND EXCAVATION SERVICE ADVISES HOME OWNERS OF THE DIGGER'S HOTLINE SERVICE.

THE INFORMATION SHOWN ON THIS DRAWING CONCERNING THE LOCATION OF UNDERGROUND UTILITIES IS NOT GUARANTEED BY THE SURVEYOR. THE CONTRACTOR IS RESPONSIBLE FOR VERIFYING THE LOCATION OF UNDERGROUND UTILITIES AS NECESSARY TO AVOID DAMAGE THEREOF.

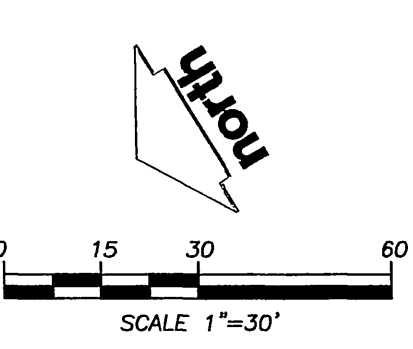

DATE	6-29-2007	DRAWN BY	SO	DATE	6-29-2007	CHECKED BY	JK	DATE	7-02-2007	APPROVED BY	DMJ	DATE	7-02-2007	DRAWN BY	JDK	DATE	7-02-2007	DESCRIPTION	DATE	BY
<p style="text-align: center;">EXISTING CONDITIONS SURVEY</p> <p style="text-align: center;">LOT 1, CERTIFIED SURVEY MAP NO. 4043, VILLAGE OF ALBANY, GREEN COUNTY, WISCONSIN</p> <p style="text-align: right;">JDK 10/10/07 5:14 PM 21-3-9</p>																				
<p style="text-align: center;">JSD Engineers & Surveyors Jenkins Survey & Design, Inc. 161 HORIZON DRIVE, SUITE 101 VERONA, WISCONSIN 53583 PHONE: (608)948-5660</p>																				
<p>PROJECT NO: 07-2829 FILE NO: E-47 SURVEYED: JWV F.B. NO./PG.: 207/14 SHEET NO.: 1 OF 1</p>																				
<p style="text-align: right;">PREPARED FOR: MONROE CLIND 512 22ND STREET MONROE, WI 53566</p>																				