

# PLAT OF SURVEY

LOT 1 OF GREEN COUNTY CERTIFIED SURVEY MAP NUMBER 4220, RECORDED IN VOLUME 17 OF CERTIFIED SURVEY MAPS ON PAGE 21 AND 22, LOCATED IN THE NE 1/4-SE 1/4 AND THE SE 1/4-SE 1/4 OF SECTION 21, TOWN 4 NORTH, RANGE 6 EAST, TOWN OF YORK, GREEN COUNTY, WISCONSIN.

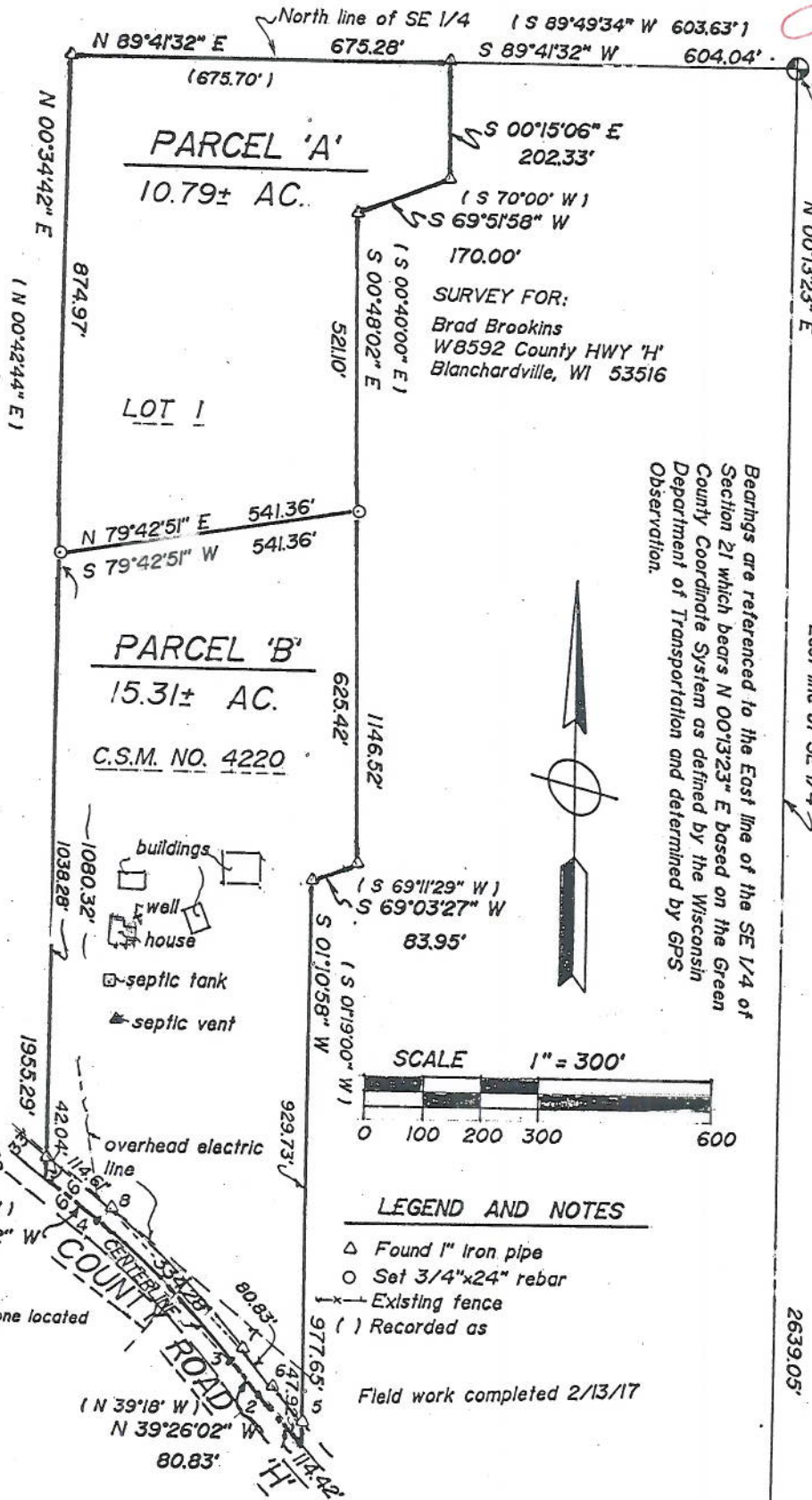
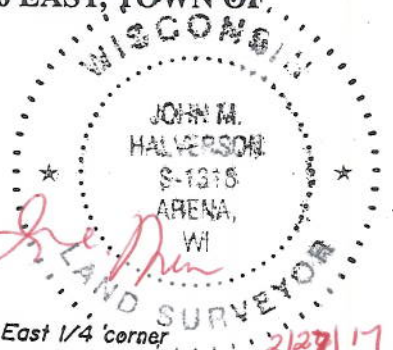

East 1/4 corner  
Section 21, T4N, R6E  
Found cast aluminum monument & ties

CURVE DATA TABLE

CURVE NO	RADIUS	ARC	CENTRAL ANGLE	CHORD BEARING	LENGTH
1-2	1909.86'	114.42'	03°25'58"	N 41°09'01" W	114.40'
3-4	1637.02'	334.28'	11°44'00"	N 45°17'02" W	333.70'
5-6	1876.06'	78.00'	02°22'52"	N 40°37'28" W	77.99'
7-8	1670.02'	341.02'	11°42'00"	N 45°17'02" W	340.43'

Bearings are referenced to the East line of the SE 1/4 of Section 21 which bears N 00°13'23" E based on the Green County Coordinate System as defined by the Wisconsin Department of Transportation and determined by GPS Observation.

( N 51°00' W )  
N 51°08'02" W  
115.56'  
Buried telephone located on Parcel 'B'

### LEGEND AND NOTES

- △ Found 1" Iron pipe
- Set 3/4"x24" rebar
- Existing fence
- ( ) Recorded as

Field work completed 2/13/17

Parcel 'A' is to be conveyed to an adjacent landowner. Per Green County Zoning Department, this is considered a lot line adjustment.

Field Mar. 27, 2017 UTM 15 pg 84