

PLAT OF SURVEY

LOCATED IN THE NW ¼-NE ¼, THE SW ¼-NE ¼, THE SE ¼-NE ¼, THE NW ¼-SE ¼, THE NE ¼-NW ¼, THE SE ¼-NW ¼, THE NE ¼-SW ¼, INCLUDING LOT 1 OF GREEN COUNTY CERTIFIED SURVEY MAP NUMBER 1291 AND ALSO INCLUDING LOT 2 OF GREEN COUNTY CERTIFIED SURVEY MAP NUMBER 4487, ALL IN SECTION 32, TOWN 3 NORTH, RANGE 6 EAST, TOWN OF ADAMS, GREEN COUNTY, WISCONSIN.

LEGAL DESCRIPTION OF PARCEL 'A'

A parcel of land located in the NW ¼-NE ¼, the SW ¼-NE ¼, the SE ¼-NE ¼, the NW ¼-SE ¼, the NE ¼-NW ¼, the SE ¼-NW ¼, the NE ¼-SW ¼, including Lot 1 of Green County Certified Survey Map Number 1291 and also including Lot 2 of Green County Certified Survey Map Number 4487, all in Section 32, Town 3 North, Range 6 East, Town of Adams, Green County, Wisconsin, more particularly described as follows:

Commencing at the North ¼ corner of said Section 32; thence N 89°28'26" E, 262.00 feet along the North line of the NE ¼ of said Section 32 to the point of beginning; thence S 45°46'13" E, 751.66 feet; thence S 06°41'55" W, 612.16 feet; thence S 74°23'27" W, 291.29 feet to an existing 3/4" rebar on the East line of Lot 1 of Green County Certified Survey Map Number 4487; thence N 04°14'59" E, 153.35 feet along the East line of Green County Certified Survey Map Number 4487 to an existing 3/4" rebar; thence N 83°46'07" W, 477.45 feet along the North line of Lot 1 of Green County Certified Survey Map Number 4487 to a point in the centerline of Rat Hollow Road; thence Northeasterly, 75.86 feet along the arc of a curve to the left having a central angle of 22°17'24" and a radius of 195.00 feet, said arc also being the centerline of Rat Hollow Road, the long chord of which bears N 08°29'58" E, 75.38 feet; thence N 02°38'44" W, 147.78 feet along the centerline of Rat Hollow Road; thence Northwesterly, 205.08 feet along the arc of a curve to the left having a central angle of 08°41'50" and a radius of 1351.00 feet, said arc also being the centerline of Rat Hollow Road, the long chord of which bears N 06°59'39" W, 204.88 feet; thence N 11°20'34" W, 454.59 feet along the centerline of Rat Hollow Road; thence N 09°04'44" W, 134.20 feet along the centerline of Rat Hollow Road to a point on the North line of the NE ¼-NW ¼ of said Section 32; thence N 89°52'59" W, 1183.28 feet along the North line of the NE ¼-NW ¼ of said Section 32; thence S 00°29'10" E, 1325.48 feet along the West line of the NE ¼-NW ¼; thence S 00°29'10" E, 1325.38 feet along the West line of the SE ¼-NW ¼; thence S 00°55'10" E, 1342.68 feet along the West line of the NE ¼-SW ¼; thence S 89°28'36" E, 1327.21 feet along the South line of the NE ¼-SW ¼; thence N 00°36'08" W, 1356.93 feet along the East line of the NE ¼-SW ¼; thence N 89°54'16" E, 1333.06 feet along the South line of the SE ¼-NE ¼; thence N 00°41'55" W, 166.19 feet along the West line of the SE ¼-NE ¼; thence N 89°54'16" E, 1332.78 feet; thence N 00°47'38" W, 1166.82 feet along the East line of the SE ¼-NE ¼; thence S 89°41'23" W, 1330.80 feet along the North line of the SE ¼-NE ¼; thence N 00°41'55" W, 1328.00 feet along the East line of the NW ¼-NE ¼; thence S 89°28'26" W, 1066.55 feet along the North line of the NE ¼-NW ¼; thence N 00°41'55" W, 166.17 feet along the West line of the SE ¼-NE ¼; along the East line of the SW ¼-NE ¼ to the point of beginning, EXCLUDING THEREFOM Lot 1 of Green County Certified Survey Map Number 4487, containing 214.93 acres, more or less.

LEGAL DESCRIPTION - RESIDENTIAL ZONE AREA:

A parcel of land located in the NW ¼-NE ¼ and the NE ¼-NW ¼ of Section 32, Town 3 North, Range 6 East, Town of Adams, Green County, Wisconsin, described as follows:

Beginning at the North ¼ corner of said Section 32; thence N 89°28'26" E, 262.00 feet along the North line of the NE ¼ of said Section 32; thence S 45°46'13" E, 751.66 feet; thence S 06°41'55" W, 612.16 feet; thence S 74°23'27" W, 291.29 feet to an existing 3/4" rebar on the East line of Lot 1 of Green County Certified Survey Map Number 4487; thence N 04°14'59" E, 153.35 feet along the East line of Green County Certified Survey Map Number 4487 to an existing 3/4" rebar; thence N 83°46'07" W, 477.45 feet along the North line of Lot 1 of Green County Certified Survey Map Number 4487 to a point in the centerline of Rat Hollow Road; thence Northeasterly, 75.86 feet along the arc of a curve to the left having a central angle of 22°17'24" and a radius of 195.00 feet, said arc also being the centerline of Rat Hollow Road, the long chord of which bears N 08°29'58" E, 75.38 feet; thence N 02°38'44" W, 147.78 feet along the centerline of Rat Hollow Road; thence Northwesterly, 205.08 feet along the arc of a curve to the left having a central angle of 08°41'50" and a radius of 1351.00 feet, said arc also being the centerline of Rat Hollow Road, the long chord of which bears N 06°59'39" W, 204.88 feet; thence N 11°20'34" W, 454.59 feet along the centerline of Rat Hollow Road; thence N 09°04'44" W, 134.20 feet along the centerline of Rat Hollow Road to a point on the North line of the NE ¼-NW ¼; thence S 89°52'59" E, 145.84 feet along the North line of said NE ¼-NW ¼ to the point of beginning, containing 17.62 acres, more or less, or 16.80 acres, more or less, excluding public highway right-of-way.

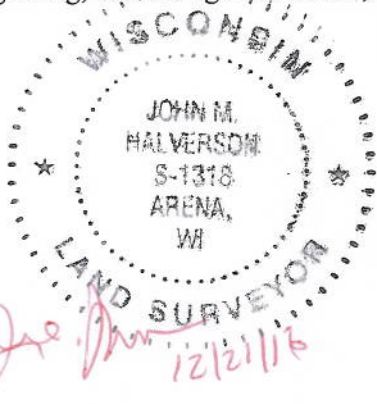

Filed
Mar. 27, 2017
UTW
15 pg
83