

BLOCK 2  
ALONZO MELVIN'S ADDITION  
TO THE VILLAGE OF BROOKLYN

PREPARED FOR:  
GENESIS HOUSING INC.  
230 SOUTH OAK STREET  
OREGON, WI 53575

SCALE 1" = 20'

LEGEND

- = SET 3/4"x24" REBAR  
WT 15 LB PER LIN FT
- = FOUND 3/4" REBAR
- = FOUND 1" IRON PIPE  
(UNLESS NOTED)
- (##) = RECORDED AS
- = MANHOLE
- = WATER VALVE
- = UTILITY PEDESTAL
- \* = GAS METER
- = UTILITY BOX / TRANSFORMER
- △ = FIRE HYDRANT
- ⊕ = POWERPOLE
- = LIGHT POLE
- + = FLAG POLE
- SAN — = SANITARY SEWER
- W — = WATER MAIN
- T — = UNDERGROUND COMMUNICATION
- E — = UNDERGROUND ELECTRIC
- G — = UNDERGROUND GAS MAIN
- DHU — = OVER HEAD UTILITIES

FIRST STREET

BOWMAN STREET

RAILROAD

STREET

PARCEL 'A'  
80,014 SQ. FT.  
OR 11.84 ACRES

EXISTING BUILDING  
101 BOWMAN STREET  
BROOKLYN, WI 53521

DESCRIPTION: PER DOC. No. 250056

A part of Lot 1 in Block 3 in Alonzo Melvin's Addition to the Village of Brooklyn, all of Outlot 132 and part of Outlot 134 of the Assessor's Plat of the Village of Brooklyn, all more particularly described as follows:  
Commencing at the northeast corner of Lot 1 of Block 3 in Alonzo Melvin's addition to the Village of Brooklyn, thence West along the North line of Lot 1 to the Northwest corner thereof, continuing thence West to the northeast corner of Outlot 133 of Assessor's Plat to the Village of Brooklyn, thence South along the East line of Outlot 133, 85 feet to the southeast corner thereof, thence West along the South line of Outlot 133 and said South line extended 131.6 feet to the West line of Outlot 134 of said Assessor's Plat of the Village of Brooklyn, thence South along the West line of Outlot 134, 146 feet to the Southwest corner thereof, thence East along the South line of Outlot 134, and the South line extended, to a point in the South line of Lot 1 in Block 3 in Alonzo Melvin's Addition aforesaid, 184 feet West of the southeast corner thereof, thence North 115.5 feet; thence East 119 feet to the Easterly line of said Lot 1, thence northwesterly along the Easterly line of said Lot 1 to the place of beginning. Being in Green County, Wisconsin.

NOTES:

- THIS SURVEY WAS PREPARED WITHOUT BENEFIT OF A TITLE REPORT FOR THE SUBJECT TRACT OR ADJOINERS AND IS THEREFORE SUBJECT TO ANY EASEMENTS, AGREEMENTS, RESTRICTIONS AND STATEMENT OF FACTS REVEALED BY EXAMINATION OF SUCH DOCUMENTS.
- WETLANDS, IF PRESENT, HAVE NOT BEEN DELINEATED OR SHOWN.
- FLOOD PLAIN, IF PRESENT, HAS NOT BEEN LOCATED OR SHOWN.
- ALL UTILITIES SHOWN ON THIS SURVEY WERE FIELD LOCATED FROM GROUND MARKINGS PLACED BY THE UTILITY COMPANIES OR THEIR AGENTS OR ESTABLISHED FROM PLANS PROVIDED BY OTHERS, EXCEPT WHERE SNOW OR OTHER OBSTACLES MAY HAVE OBSCURED THE LOCATION OF THE UTILITIES. IT IS THE RESPONSIBILITY OF THE OWNERS/CONTRACTORS TO CALL DIGGER'S HOTLINE FOR EXACT LOCATION OF UNDERGROUND UTILITIES BEFORE ANY CONSTRUCTION OR EXCAVATING IS DONE.  
DIGGER'S HOTLINE NO. 1-800-242-8531  
DIGGER'S HOTLINE TICKET NO. 2016-4075346

SURVEYOR'S CERTIFICATE:

This plat and survey were performed under my supervision, and was surveyed, divided, and mapped according to the official records of the property described and pictured hereon. This plat is a true scaled and dimensioned representation of the boundaries, buildings, improvements and all visible encroachments if any.

Williamson Surveying and Associates, LLC  
by Noa T. Prieve & Chris W. Adams

Date 11-30-2016

Noa T. Prieve S-2499  
Professional Land Surveyor

SURVEYOR'S SEAL

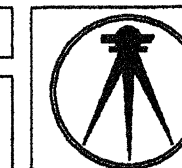
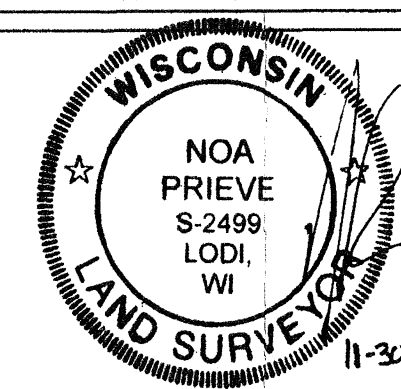

WILLIAMSON SURVEYING & ASSOCIATES, LLC  
104 A WEST MAIN STREET, WAUNAKEE, WISCONSIN, 53597.  
NOA T. PRIEVE & CHRIS W. ADAMS  
PROFESSIONAL LAND SURVEYORS

PHONE: 608-255-5705 FAX: 608-849-9760 WEB: WILLIAMSONSURVEYING.COM

PLAT OF SURVEY

Part of Lot 1, Block 3, Alonzo Melvin's Addition to the Village of Brooklyn, and all of Outlot 132 and part of Outlot 134, Assessor's Plat to the Village of Brooklyn, located in Green County, Wisconsin.

|          |                   |               |             |         |
|----------|-------------------|---------------|-------------|---------|
| DATE     | NOVEMBER 28, 2016 | REVISION DATE | CHECK BY    | N.T.P.  |
| SCALE    | 1" = 20'          |               | DRAWING NO. | 16V-407 |
| DRAWN BY | NEIL BORTZ        |               | SHEET       | 1 OF 1  |