

PLAT OF SURVEY

LOCATED IN THE SOUTHWEST ¼-SOUTHWEST ¼ OF SECTION 5, THE SOUTHEAST ¼-SOUTHEAST ¼ OF SECTION 6, THE NORTHEAST ¼-NORTHEAST ¼ OF SECTION 7, AND THE NORTHWEST ¼-NORTHWEST ¼ OF SECTION 8, ALL IN TOWN 4 NORTH, RANGE 6 EAST, TOWN OF YORK, GREEN COUNTY, WISCONSIN.

SURVEYOR'S CERTIFICATE:

I, John M. Halverson, Professional Land Surveyor, hereby certify that I have surveyed, divided, and mapped a part of the Southwest ¼ of the Southwest ¼ of Section 5, the Southeast ¼ of the Southeast ¼ of Section 6, the Northeast ¼ of the Northeast ¼ of Section 7, and the Northwest ¼ of the Northwest ¼ of Section 8, all in Town 4 North, Range 6 East, Town of York, Green County, Wisconsin, described as follows:

Commencing at the Northeast corner of said Section 7; thence N 06°46'34" W, 24.15 feet to the point of beginning; thence N 78°37'00" E, 354.46 feet; thence S 15°40'00" W, 83.14 feet; thence S 40°48'37" W, 675.31 feet; thence S 65°27'35" W, 334.62 feet; thence N 29°29'12" W, 161.98 feet; thence S 44°53'00" W, 1103.68 feet; thence N 00°23'35" W, 381.60 feet along the West line of the NE ¼-NE ¼ of said Section 7; thence N 33°01'00" E, 429.35 feet; thence N 31°17'34" E, 548.67 feet; thence N 36°40'08" E, 43.82 feet; thence N 24°11'41" E, 45.79 feet; thence N 88°26'20" W, 169.16 feet to a point on the Southeasterly r/w line of State Road "78"; thence N 33°58'42" E, 370.29 feet along the Southeasterly right-of-way line of State Road "78"; thence N 41°02'53" E, 318.32 feet along the Southeasterly right-of-way line of State Road "78"; thence N 55°21'09" E, 325.69 feet along the Southeasterly right-of-way line of State Road "78"; thence N 62°35'13" E, 515.73 feet along the Southeasterly right-of-way line of State Road "78"; thence N 69°05'33" E, 483.18 feet along the Southeasterly right-of-way line of State Road "78"; thence N 75°53'07" E, 65.31 feet along the Southeasterly right-of-way line of State Road "78"; thence S 01°41'50" W, 369.88 feet; thence S 68°14'50" W, 841.64 feet; thence S 02°51'25" E, 467.84 feet to the point of beginning, containing 35.01 acres, more or less.

That I have prepared the above certified survey map at the request of the Pat Reichling.

I hereby certify that this survey is in compliance with AE 7 of the Administrative Code of the State of Wisconsin, and that I have surveyed, divided, mapped, and monumented the above described lands, and that this map is a true and correct representation of the lands surveyed to the best of my knowledge and belief.

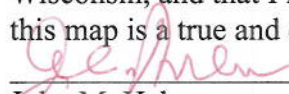
John M. Halverson
Professional Land Surveyor
6381 Coon Rock Road
Arena, WI 53503

Dated this 11th day of October, 2015

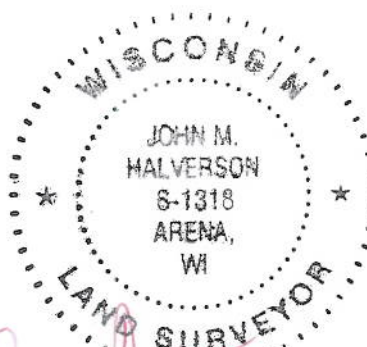

10/11/16

Filed Oct. 14, 2016 VAE 15 pg 62