

ALTA / NSPS LAND TITLE SURVEY

THAT PART OF FRACTIONAL LOT 4, OF SECTION 3, TOWNSHIP 1 NORTH, RANGE 7 EAST, LOT 1 OF CERTIFIED SURVEY MAP NO. 502, RECORDED IN VOLUME 2 OF CERTIFIED SURVEY MAPS OF GREEN COUNTY, ON PAGE 30, AS DOCUMENT NO. 275590 AND OTHER LANDS BEING PART OF THE SE 1/4 AND SW 1/4 OF THE SW 1/4, OF SECTION 34, TOWNSHIP 2 NORTH, RANGE 7 EAST, CITY OF MONROE, GREEN COUNTY, WISCONSIN.

TITLE COMMITMENT NUMBER: FA5391

SCHEDULE B - SECTION II EXCEPTIONS

- 10 AN AGREEMENT from Orpha A. Crow and Maria Crow to The City of Monroe by an instrument dated July 17, 1894 and recorded in the office of the Register of Deeds for Green County, WI on October 8, 1894 in Vol. 70 Deeds page 212 as Doc. No. 74952a ... to lay a sewer main ... over the NW and SE of the SW of Sec. 34, T2N, R7E Green County, WI. (Parcel 1) This is a blanket easement, unable to graphically show on this survey.
- 11 RIGHT OF WAY by and between Robert Crow and Orpha Crow to Chicago, Madison and Northern Railroad Co. dated February 23, 1887 and recorded in the office of the Register of Deeds for Green County, WI on November 23, 1915 in Vol. 3 Misc. page 409 as Doc. No. 109158 ... conveying a strip of land 50 feet wide on the east and 50 feet wide on the other side of the centerline to the track. (Parcel 1) This is graphically shown on this survey.
- 12 UTILITY EASEMENT from John J. Flannery and Mrs. Elizabeth Flannery, his wife to Wisconsin Utilities Co. dated May 5, 1924 and recorded in the office of Register of Deeds for Green County, WI on May 20, 1924 in Vol. 65 Deeds page 435 as Doc. No. 125181a ... over the SW 1/4 of Sec. 34, T2N, R7E, Green County, WI. (Parcel 1) This is a blanket easement, unable to graphically show on this survey.
- 13 EASEMENT from Ozora H. Thorp and Letha Thorp, his wife to City of Monroe by an instrument dated April 28, 1931 and recorded in the office of the Register of Deeds for Green County, WI on May 20, 1931 in Vol. 6 Misc. page 543 as Doc. No. 136642a ... to erect & maintain poles, wires, anchors and other appliances necessary in the conduct of its business ... described as parallel with or approximately parallel with the course of the stream flowing through grantor's land and known now as Thunder Creek ... the land being in Sec. 34, T2N, R7E, Green County, WI. (Parcel 1) This is a blanket easement, unable to graphically show on this survey.
- 14 EASEMENT agreement from Arthur P. Stauffacher and Helen Stauffacher, his wife, Gordon Stauffacher, single, Charles J. Stauffacher and Alice Stauffacher, his wife by Arthur P. Stauffacher, attorney in fact to City of Monroe by an instrument dated April 25, 1931 and recorded in the office of the Register of Deeds for Green County, WI on May 20, 1931 in Vol. 6 Misc. page 543 as Doc. No. 136643a ... over Section 34, T2N, R7E, City of Monroe, Green County, WI. (Parcel 1) This is a blanket easement, unable to graphically show on this survey.
- 15 EASEMENT from Beatrice Brohm, Special Guardian of Marshall Stauffacher, infant heir of Peter Stauffacher, dec'd. to the City of Monroe by an instrument dated June 30, 1931 and recorded in the office of the Register of Deeds for Green County, WI on July 1, 1931 in Vol. 104 Deeds page 222 as Doc. No. 136789 ... over 55.85 acres in Sec. 34, T2N, R7E, Green County, WI ... for the construction of an electrical line to the Sewage Disposal Plant. (Parcel 1) This is a blanket easement, unable to graphically show on this survey.
- 16 UTILITY EASEMENT from Frieda Spaeni and Elsie Gerber to Wisconsin Power & Light Company by an instrument dated on September 14, 1935 and recorded in the office of the Register of Deeds for Green County, WI on September 16, 1935 in Vol. 8 Misc. page 85 ... along North side of road running approximately East and West land owned by Elsie Gerber and Frieda Spaeni and described as 5 1/2 acres in extreme Northwest Quarter of Northwest Quarter of Sec. 3, T1N, R7E, Green County, WI. (Parcel 2) This is a blanket easement, unable to graphically show on this survey.
- 17 DECLARATION OF EASEMENT between William H. Robichaux and Patricia A. Robichaux and City of Monroe by an instrument dated June 26, 1986 and recorded in the office of the Register of Deeds for Green County, WI on July 3, 1986 in Vol. 396 Records, page 812 as Doc. No. 304555 ... to install, operate, maintain & repair the water main extension system, including water mains, pipes, conduits and any other necessary appurtenances through, under and across the Southeastern 2 feet of the insured real estate. (Parcel 2) This is a blanket easement, unable to graphically show on this survey.
- 18 POSSIBLE FUTURE ASSESSMENT for sidewalk improvements by the City of Monroe. (Parcel 1 and Parcel 2) Unable to graphically show on this survey.
- 19 TERMS AND CONDITIONS CONTAINED IN DRIVEWAY AGREEMENT by and between Saputo Cheese USA Inc, a Delaware Corporation and Marshall D. Zwygart by an instrument dated July 26, 2002 and recorded in the office of the Register of Deeds for Green County, WI on July 29, 2002 in Vol. 738 of Records, Page 624 as Doc. No. 431654. (Parcel 1) This easement is graphically shown on this survey.
- 20A EASEMENT AGREEMENT WITH TERMS AND CONDITIONS by and between John Bruni and Lugano Cheese Co., Inc. a Wisconsin Corporation by an instrument dated February 16, 1981 and recorded in the office of the Register of Deeds for Green County, WI on March 2, 1981 in Vol. 351 of Records, Page 302 as Doc. No. 281333. (Parcel 1) This easement is graphically shown on this survey.
- 20B EASEMENT AGREEMENT WITH TERMS AND CONDITIONS by and between John Bruni and Roy's Dairy, Inc. by an instrument dated March 18, 1986 and recorded in the office of the Register of Deeds for Green County, WI on March 19, 1986 in Vol. 393 of Records, Page 625 as Doc. No. 302970. (Parcel 1) This easement is graphically shown on this survey.
- 20C TERMS AND CONDITIONS CONTAINED IN AGREEMENT by Saputo Cheese USA Inc. to The Public by an instrument dated September 17, 2002 and recorded in the office of the Register of Deeds for Green County, WI on September 17, 2002 in Vol. 747 of Records, Page 813 as Doc. No. 433539. (Parcel 1) This easement is graphically shown on this survey.
- 21A SEWER ACCESS AGREEMENT WITH TERMS AND CONDITIONS by and between Avonmore Cheese, Inc. of Monroe, a Wisconsin Corporation and Honey Creek Foods, Inc., a Missouri Corporation by an instrument dated May 13, 1994 and recorded in the office of the Register of Deeds for Green County, WI on May 17, 1994 in Vol. 500 of Records, Page 30 as Doc. No. 351479. (Parcel 1) This easement is graphically shown on this survey.
- 21B SEWER ACCESS AND EASEMENT AGREEMENT WITH TERMS AND CONDITIONS by and between International Ingredient Corporation, a Missouri Corporation and Jeffrey R. Voegeli and Annette A. Voegeli by an instrument dated January 6, 2006 and recorded in the office of the Register of Deeds for Green County, WI on January 17, 2006 in Vol. 951 of Records, Page 208 as Doc. No. 481076. (Parcel 1) This is a blanket easement, unable to graphically show on this survey.
- 21C AGREEMENT FOR SEWER CONNECTION WITH TERMS AND CONDITIONS by and between Saputo Cheese USA Inc., a Delaware Corporation and Jeffrey R. Voegeli and Annette A. Voegeli by an instrument dated January 6, 2006 and recorded in the office of the Register of Deeds for Green County, WI on January 23, 2006 in Vol. 951 of Records, Page 806 as Doc. No. 481215. (Parcel 1) This is a blanket easement, unable to graphically show on this survey.
- 22 UTILITY EASEMENT from Saputo Cheese, USA Inc. to Utelco, Inc. d/b/a TDS Telecom by an instrument dated June 11, 2003 and recorded in the office of the Register of Deeds for Green County, WI on July 8, 2003 in Vol. 820 of Records, Page 90 as Doc. No. 448444. (Parcel 2) This easement is graphically shown on this survey.
- 23 RIGHTS OF THE PUBLIC in that portion of the subject premises lying within the limits of 11th Street as referenced on Certified Survey Map Number 502. (Parcel 1) This is graphically shown on this survey.

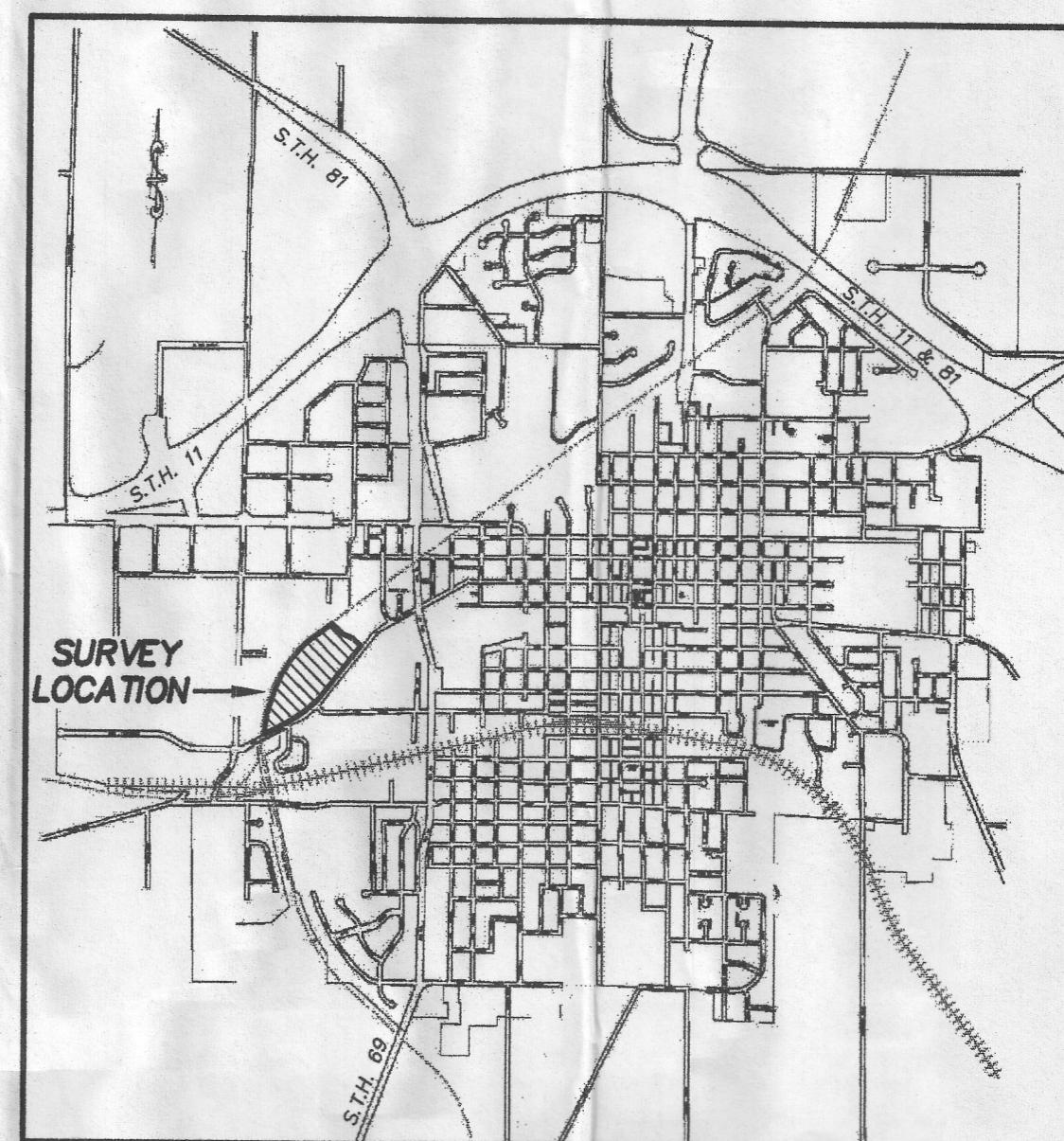

CITY OF MONROE
VICINITY MAP:
NOT TO SCALE

BUILDING INFORMATION:

BUILDING	AREA	DIMENSIONS	HEIGHT
1	6,488 SQ. FT.	70.3' X 92.3'	ROOF PEAK 20.7' ABOVE EXISTING GROUND ON SOUTH SIDE
2	182 SQ. FT.	11.9' X 15.3'	ROOF PEAK 13.0' ABOVE EXISTING GROUND AT NW CORNER
3	2,318 SQ. FT.	32.1' X 72.2'	ROOF PEAK 16.3' ABOVE EXISTING GROUND ON EAST SIDE
4	23 SQ. FT.	5.1' X 4.5'	ROOF PEAK 11.2' ABOVE EXISTING GROUND ON NORTH SIDE
5	192 SQ. FT.	12.0' X 16.0'	ROOF PEAK 13.7' ABOVE EXISTING GROUND AT NE CORNER
6	20,900 SQ. FT.	SEE DETAIL	ROOF PEAK 17.5' ABOVE EXISTING GROUND AT SW CORNER

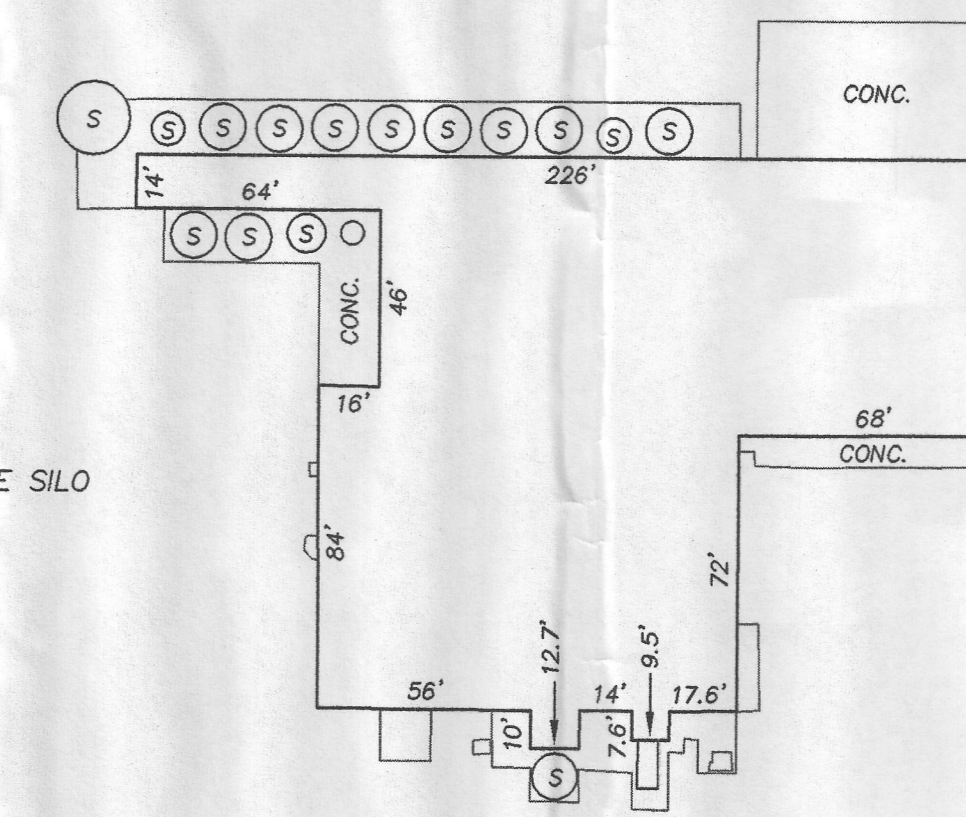

LEGEND:
⊙ OUTDOOR STORAGE SILO

BUILDING 6 DETAIL:

SCALE: 1" = 50'

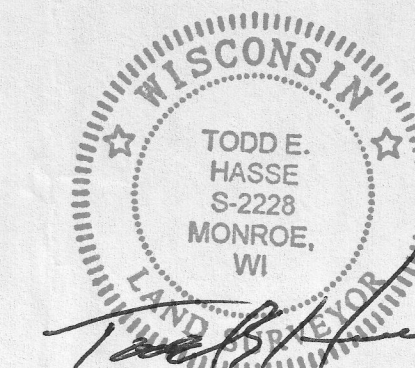

August 29th, 2016

PREPARED FOR:

SAPUTO CHEESE USA, INC.
ONE OVERLOOK POINT, SUITE 300
LINCOLNSHIRE CORPORATE CENTER
LINCOLNSHIRE, IL 60069
(847) 267-1100

JOB NO. 16099
DRAWING C:\DRAWINGS\PLATS\16099.DWG

HASSE
SURVEYING, LLC
W5820 ILIFF ROAD
MONROE, WI 53566
(808) 325-5321 PHONE
(808) 329-5321 FAX
hasseurveying@wekz.net

Filed
Sept 19, 2016
Vol 15
Pg 54