

# PLAT OF SURVEY

Lot 9 of Hillside Acres, Recorded in Hanging File 20B of the Green County Register of Deeds Office, as Document No. 225084, being part of the NW 1/4 of the NE 1/4 of Section 35, Township 2 North, Range 7 East, City of Monroe, Green County, Wisconsin, bounded and described as follows:

I, Todd E. Hasse, Professional Land Surveyor, S-2228, hereby certify that I have made this Plat of Survey under the direction of Melody & Francis Loeffelholz and that I have surveyed, monumented and mapped the lands described hereon and that this map is a correct representation thereof in accordance with the information that was provided.

August 8th, 2017

*Todd E. Hasse*  
Todd E. Hasse P.L.S. - 2228

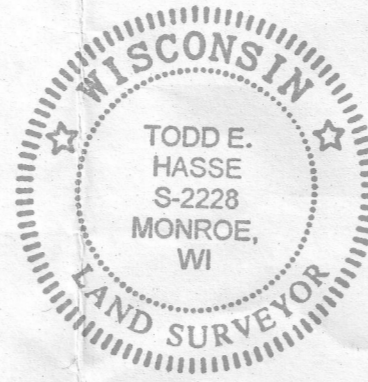

### NOTES:

- Bearings and distances shown in parenthesis, indicates recorded as data.
- Bearings are referenced to the North line of the NE 1/4 of Section 35, which bears S89°36'34"E, according to the Green County Coordinate System, as defined by the Wisconsin Department of Transportation and determined by GPS observation, 2007 Adjustment.
- There seems to be an overlap between the Hillside Acres and Ladwig Addition Subdivision Plats as graphically shown. I found the existing monumentation as was set by Surveyor Harvey Elmer for the Hillside Acres Plat and held these points as controlling for this survey.

## "DONNY ADDITION TO HILLSIDE ACRES"



PREPARED FOR:  
Melody & Francis Loeffelholz  
316 27TH AVENUE  
MONROE, WI 53566  
(608) 426-4249