

100 Year Flood Elevation Plot Map

**LOT 1 OF GREEN COUNTY
CERTIFIED SURVEY MAP No.3121
VOLUME 11, PAGE 158**

SE 1/4 SE 1/4 + SW 1/4 SE 1/4 2-4-8

REFERENCE TO FEMA COMMUNITY PANEL NUMBER 550157 0030 PANEL 30 OF 145

**KARNS LAND SURVEYING
N 7994 KELLY ROAD
BROOKLYN, WI. 53521
608-862-3811
608-293-3811
608-575-7486**

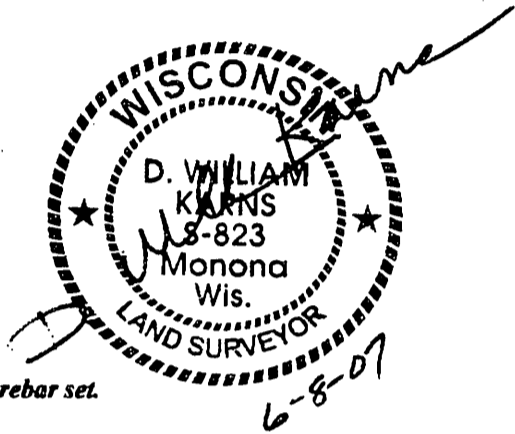

100 YEAR FLOOD ELEVATION = 851.9' AT LOT 1

LEGEND: SCALE 1"= 100'

● = 3/4" DIAM REBAR FOUND.

○ = 3/4"x 18" rebar set.

= 100 YEAR FLOOD ELEVATION LINE.

JUNE 8th 2007
f.b.# 128, P.146

**LOCAL BENCH MARK IN 12" DIAM. OAK TREE ON SOUTH SIDE OF LOT APP. 3' ABOVE GROUND ON W. SIDE
60d RINGSHANK SPIKE ELEVATION = 871.1'**

ELEVATION OF BASEMENT FLOOR AT WALKOUT = ~~860.7'~~

**FOR: FORREST & JANE LIPKE
N 9393 WOODDUCK CIRCLE
BELLEVILLE, WI. 53508
(608) 424-1996**

Filed Aug. 15, 2007 Vol 11 page 164

