

N1/4 COR. SEC. 6-3-9

PLAT of SURVEY

SURVEYORS CERTIFICATE:

I HEREBY CERTIFY THAT THIS SURVEY IS IN COMPLIANCE WITH CHAPTER A-E7 OF THE WISCONSIN ADMINISTRATIVE CODE. I FURTHER CERTIFY THAT AT THE DIRECTION OF JEFF KITTLESEN I HAVE SURVEYED, DIVIDED & MAPPED THE LANDS DESCRIBED HEREON AND THAT THE MAP IS A CORRECT REPRESENTATION OF SAID SURVEY.

John R. Karns
JOHN R. KARNS RLS-1295

FOR:
JEFF KITTLESEN
3120 HIGHLAND BLVD.
MOUND, MN. 55364

KARNS LAND SURVEYING
N 7994 Kelly Road
Brooklyn, WI 53521
Phone: (608) 862-3811

S1/4 CORNER SEC. 6-3-9

SW CORNER SEC. 5-3-9

SEFFROOD to KITTLESEN ACCESS EASEMENT

A perpetual easement for purposes of ingress and egress 10 feet either side of the following described centerline located in the NW1/4 of the NW1/4 of section 8, T3N-R9E, Town of Albany, Green County, Wisconsin; to-wit: commencing at the NW corner of said Section 8; thence N 89°34'16"E along the N line said NW1/4, 254.0 feet to the point of beginning of this description; thence S 0°37'33"W, 258.62 feet to the N line of Green County Certified Survey Map #3558, Vol. 13, P. 201 and the end of this description. The intent of this description is to follow the existing drive to the property to the North.

PARCEL CONTAINS 65.56 Acres, inc.

DESCRIPTION:

A PART OF THE SW1/4 OF THE SW1/4 OF SECTION 5; A PART OF THE SE1/4 OF THE SE1/4 AND A PART OF THE SW1/4 OF THE SE1/4 OF SECTION 6; AND A PART OF THE NE1/4 OF THE NE1/4 OF SECTION 7, ALL IN T3N-R9E, TOWN OF ALBANY, GREEN COUNTY, WISCONSIN; TO-WIT COMMENCING AT THE SW CORNER OF SAID SECTION 5 AND THE POINT OF BEGINNING OF THIS DESCRIPTION; THENCE S 00°00'02"E, 796.97 FEET; THENCE S 40°43'38"W, 324.12 FEET; THENCE S 07°02'45"W, 303.91 FEET; THENCE S 88°33'30"W, 1078.94 FEET; THENCE N 00°37'59"W, 1342.31 FEET; THENCE S 88°45'23"W, 1340.36 FEET TO THE S1/4 CORNER OF SECTION 6; THENCE N 00°06'21"W, 1184.39 FEET; THENCE S 88°34'59"E, 404.79 FEET; THENCE S 03°36'59"E, 740.29 FEET; THENCE N 88°16'32"E, 308.31 FEET; THENCE S 47°09'06"E, 334.50 FEET; THENCE N 89°17'02"E, 1434.46 FEET; THENCE N 01°41'56"W, 225.71 FEET; THENCE N 87°54'27"E, 227.79 FEET; THENCE S 49°22'41"E, 313.53 FEET; THENCE S 16°32'15"E, 213.64 FEET; THENCE S 89°34'16"W, 274.45 FEET TO THE POINT OF BEGINNING. CONTAINING 65.56 ACRES.

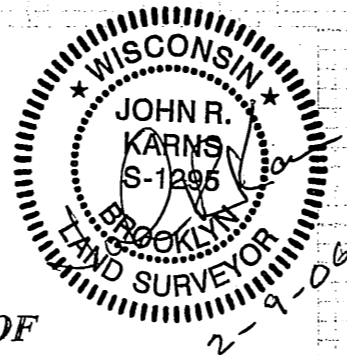

LEGEND: SCALE 1"= 200'

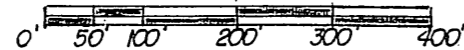

● = 3/4"x 18" rebar set, mn. wt. 1.5# per ln. ft.

■ = cast aluminum monument found

△ = metal R/W post found.

—x— = field fence line—all iron set are one foot outside of the fence corner.

NORTH referenced to the N-S 1/4 line of section 6-3-9, which is assumed to bear N 00°06'21"W.

Field Feb. 15, 2006 08:11 pg 50