

Plat of survey
For: David & Linda Jeremiason
c/o Attorney Ralph Farrell
Job #2005-64
Sheet 2 of 2

PARCEL DESCRIPTION:

The NW 1/4 of the SW 1/4, SW 1/4 of the SW 1/4, SE 1/4 of the SW 1/4, and parts of the SW 1/4 of the SE 1/4, NE 1/4 of the SE 1/4, and NW 1/4 of the SE 1/4 of Section 33, T4N, R6E, York Township and part of the Fractional NE 1/4 of the NW 1/4 and Fractional NW 1/4 of the NE 1/4 of Section 4, T3N, R6E, Adams Township, all in Green County, Wisconsin, to wit:

Commencing at the W 1/4 CORNER of said Section 33; said point being the POINT OF BEGINNING; thence along the quarter section line, N 89° 47' 52" E, 1309.31' to the southwesterly line of CSM 3534; thence along said southwesterly line, S 42° 49' 37" E, 1356.09' to the centerline of Jeremiason Lane and the point of curvature of a curve, concave to the northwest, having a radius of 659.00', a central angle of 14° 23' 56", and a chord of 165.18' bearing N 34° 41' 56" E; thence northeasterly along said curve and centerline, a distance of 165.61'; thence along said centerline, N 27° 29' 58" E, 50.17'; thence along said centerline, N 28° 59' 24" E, 150.58' to the southwest corner of CSM 2301; thence along the south line of said CSM, N 83° 32' 13" E, 692.04' to the southwest corner of CSM 2736; thence along the south line of said CSM, N 83° 31' 39" E, 532.79'; thence along the south line of said CSM, S 89° 17' 47" E, 310.60' to the west line of CSM 2632; thence along said west line, S 2° 06' 47" W, 692.50'; thence along said west line, S 10° 41' 01" W, 69.14'; thence along said west line, S 36° 30' 40" W, 617.57'; thence along said west line, S 14° 07' 02" W, 340.52'; thence along said west line, S 1° 22' 03" W, 1348.94' to the southwest corner thereof; thence N 72° 51' 48" W, 1857.80'; thence N 0° 22' 24" W, 306.52' to the south line of said Section 33; thence S 89° 49' 25" W, 1728.98' to the southwest corner thereof; thence N 1° 42' 26" E, 2631.49' to the POINT OF BEGINNING; said described parcel containing 217.57 acres, more or less. Parcel is subject to an easement for Jeremiason Lane. Parcel is subject to and benefits from an easement described in Document Number 396013 and recorded in Volume 613 on Page 788. Parcel is subject to any easements, restrictions, and regulations of record.

SURVEYOR'S CERTIFICATE:

I hereby certify that I have made a survey according to the instructions and/or description furnished me and that the plat drawn is a correct representation of that survey to the best of my knowledge and belief.

Michael R. LaRosa RLS No. S-2259

10/7/2005
date

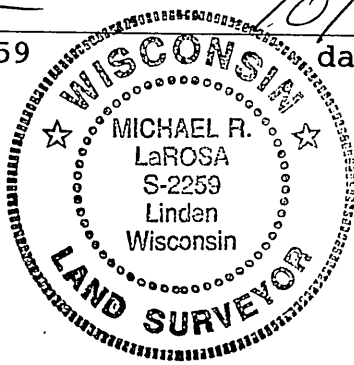

Filed Nov. 2, 2005 Vol 11 pg 28