

Plat of survey
For: Homer & Avis Hendrickson
Job #2004-72
Sheet 2 of 2

PARCEL DESCRIPTION:

A parcel of land located in part of the NE 1/4 of the NE 1/4 of Section 33 and NW 1/4 of the NW 1/4 of Section 34, all in T4N, R6E, York Township, Green County, Wisconsin, to wit:

Commencing at the NW CORNER of said Section 34; said point being the POINT OF BEGINNING; thence N 89° 38' 55" E, 1330.03' to the northeast corner of said NW 1/4 of the NW 1/4; thence along the east line of said forty, S 0° 37' 13" W, 279.14'; thence S 85° 20' 24" W, 903.68'; thence S 37° 17' 00" W, 659.16'; thence S 87° 22' 30" W, 1350.93' to the west line of said NE 1/4 of the NE 1/4; thence along said west line, N 0° 36' 46" E, 925.03' to the northwest corner of said forty; thence N 89° 44' 59" E, 1312.63' to the POINT OF BEGINNING; said described parcel containing 39.74 acres, more or less. Parcel is subject to an easement for County Trunk Highway A along the easterly side thereof. Parcel is subject to any easements, restrictions, and regulations of record.

SURVEYOR'S CERTIFICATE:

I hereby certify that I have made a survey according to the instructions and/or description furnished me and that the plat drawn is a correct representation of that survey to the best of my knowledge and belief.

Michael R. LaRosa

Michael R. LaRosa RLS No. S-2259

12/17/2004
date

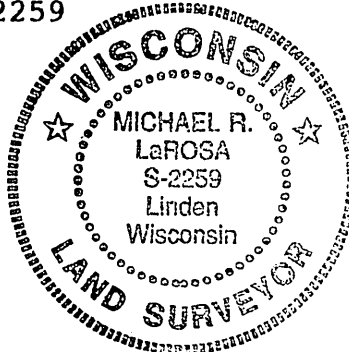

Filed Feb 21, 2005 ver 10 page 181