

Plat of survey  
For: Chuck Wellington  
Job #2004-30  
Sheet 2 of 2

PARCEL DESCRIPTION:

A parcel of land located in part of the SW 1/4 of the SE 1/4 of Section 24, T2N, R6E, Jordan Township, Green County, Wisconsin, to wit:

Commencing at the SE CORNER of said Section 24; thence N 89° 36' 36" W, 1348.46' to the southeast corner of said SW 1/4 of the SE 1/4; thence along the east line of said forty, N 0° 17' 59" E, 290.57' to the POINT OF BEGINNING; said point being in the centerline of Hiawatha Road and the beginning of a traverse northwesterly along the same as follows; said point also being the beginning of a non-tangent curve, concave to the northeast, having a radius of 1291.10', a central angle of 4° 31' 38", and a chord of 101.99' bearing N 40° 50' 57" W; thence northwesterly along said curve, a distance of 102.01'; thence N 38° 31' 47" W, 243.97'; thence N 37° 09' 18" W, 224.54' to the point of curvature of a non-tangent curve, concave to the northeast, having a radius of 2735.76', a central angle of 1° 20' 38", and a chord of 64.17' bearing N 36° 20' 47" W; thence northwesterly along said curve, a distance of 64.17' to the end of said centerline traverse; thence N 45° 29' 32" E, 340.06'; thence N 9° 27' 22" W, 47.80'; thence S 87° 47' 43" E, 161.86' to the forty line; thence S 0° 17' 59" W, 777.96' to the POINT OF BEGINNING; said described parcel containing 3.98 acres, more or less. Parcel is subject to an easement for Hiawatha Road. Parcel is subject to any easements, restrictions, and regulations of record.

**SURVEYOR'S CERTIFICATE:**

I hereby certify that I have made a survey according to the instructions and/or description furnished me and that the plat drawn is a correct representation of that survey to the best of my knowledge and belief.

*Michael R. LaRosa*

Michael R. LaRosa RLS No. S-2259

*6/8/2004*

date

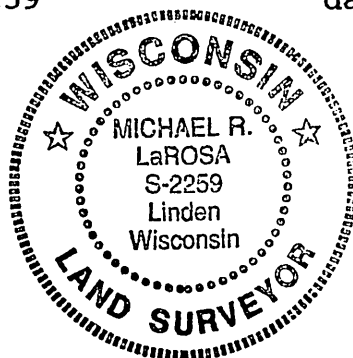

*Filed June 23, 2004 WFL 10 page 139*