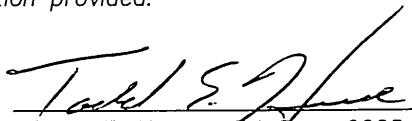

# PLAT OF SURVEY

O.L. 97 of the Assessor's Plat of the Village of Monticello, being part of the SW 1/4 of the SE 1/4 of Section 7, Town 3 North, Range 8 East, Village of Monticello, Green County, Wisconsin.

I, Todd E. Hasse, Registered Land Surveyor, S-2228, hereby certify that I have made this Plat of Survey under the direction of James Holz and that I have surveyed, monumented and mapped the lands described hereon and that this map is a correct representation thereof in accordance with the information provided.

April 26th, 2004

  
Todd E. Hasse R.L.S. - 2228

## LEGEND:

- 1" iron pipe found.
- ▲ 5/8" solid round iron rod found.
- 3/4" solid round iron rod found.
- Chiseled cross set in concrete.
- 3/4" X 24" solid round iron rod set, weighing 1.50 lbs per lineal ft.
- — Right-of-way line.
- - - Subdivision line.
- - - Property line.

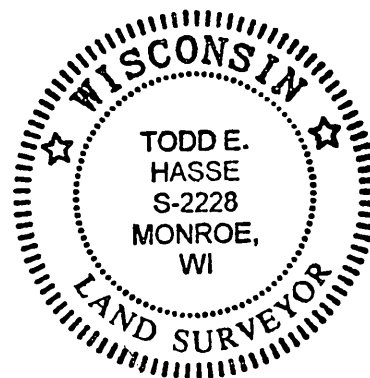

## NOTES:

1. Bearings are referenced to the E. line of South Main Street, which was assumed to bear N2°12'56"E.
2. I found a copy of the Plat of Survey shown as prepared by D. William Karns in a file supplied to me by Ekum Abstract.
3. I found no recorded information as to the right-of-way width of South Main Street at this location. I computed a straight line from the NW corner of Lot 4 of Lewis Addition, to the 5/8" iron rod I found under the concrete sidewalk at the NW corner of O.L. 92.

*filed May 25, 2004 at 10 page 128*